

K50

LABEL APPLICATOR

30 m/min speed
Label position accuracy of ± 1 mm
Labels up to 115mm wide
With mounting arm for easy installation and orientation
Ready for external printer use
Ideal for automatic labeling of products on production lines

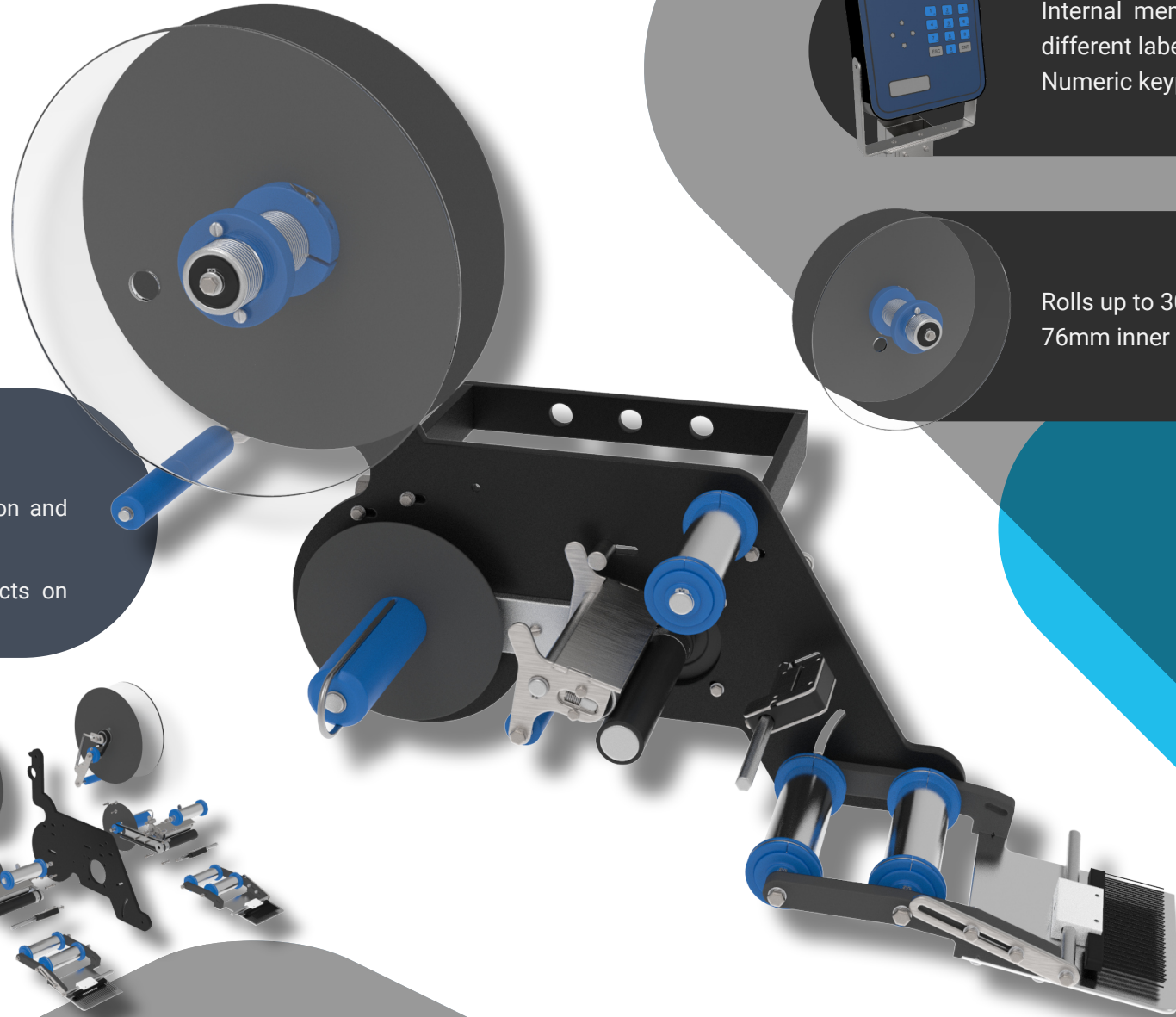
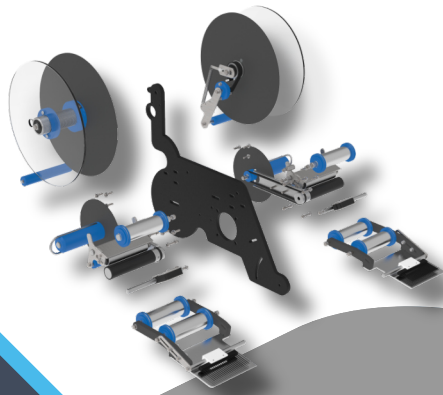

Internal memory to save up to 50 different label formats
Numeric keypad with LCD display

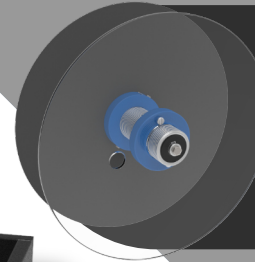

Rolls up to 300mm in diameter
76mm inner diameter



KETAN ARGENTINA S.A.
Av. Eva Perón 3491, San Martín (1650)
Buenos Aires - Argentina
Tel/Fax: (54 11) 5197-8587
E-mail: info@ketan.com.ar

The K50 head is reversible so it can be changed from left to right configuration and vice versa in the field

K50

LABEL APPLICATOR

DIMENSIONS



KETAN ARGENTINA S.A.
Av. Eva Perón 3491, San Martín (1650)
Buenos Aires - Argentina
Tel/Fax: (54 11) 5197-8587
E-mail: info@ketan.com.ar

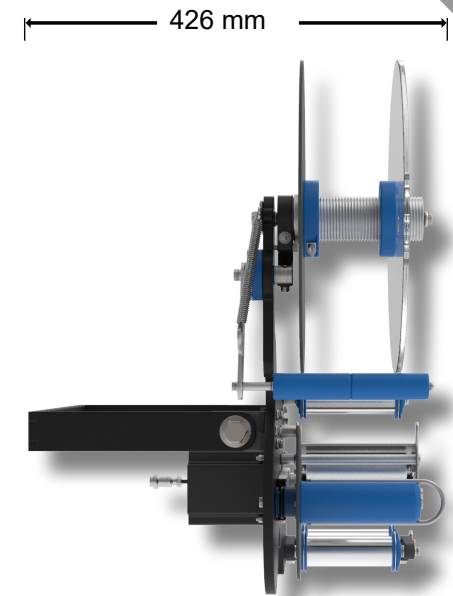
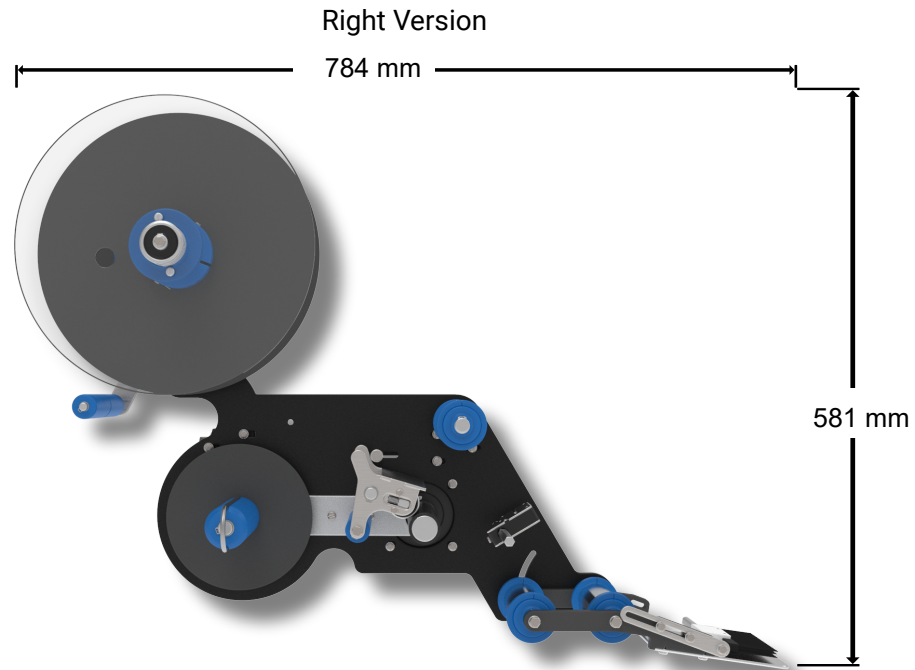

Left Version

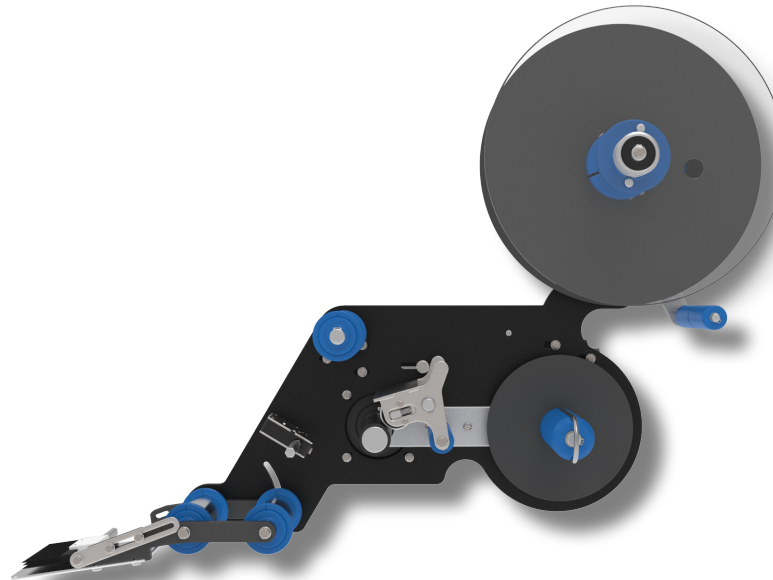

K50

LABEL APPLICATOR

SPECS

Labeling speed	Up to 30 m/min
Label width	Up to 115 mm
Paper roll outer diameter	Up to 300 mm
Paper roll inner diameter	76 mm
Power supply	350 W 220V-240V, 50Hz* 110V-120V, 60Hz*
Weight (kg)	25
Dimensions (mm)	784 x 581 x 426



KETAN ARGENTINA S.A.
Av. Eva Perón 3491, San Martín (1650)
Buenos Aires - Argentina
Tel/Fax: (54 11) 5197-8587
E-mail: info@ketan.com.ar

* To change the supply voltage contact your dealer